

## Flanged Furring Channel

### Inside Corner

- 1.) Cut 2 strips of extruded foam both at 3.5" x 2"
- 2.) Position stud "A" from the wall as depicted. Glue and nail.
- 3.) Glue the two pieces of foam (2" x 3.5") together and to the wall and install.
- 4.) Position stud "B" as depicted, glue nail/screw into place.

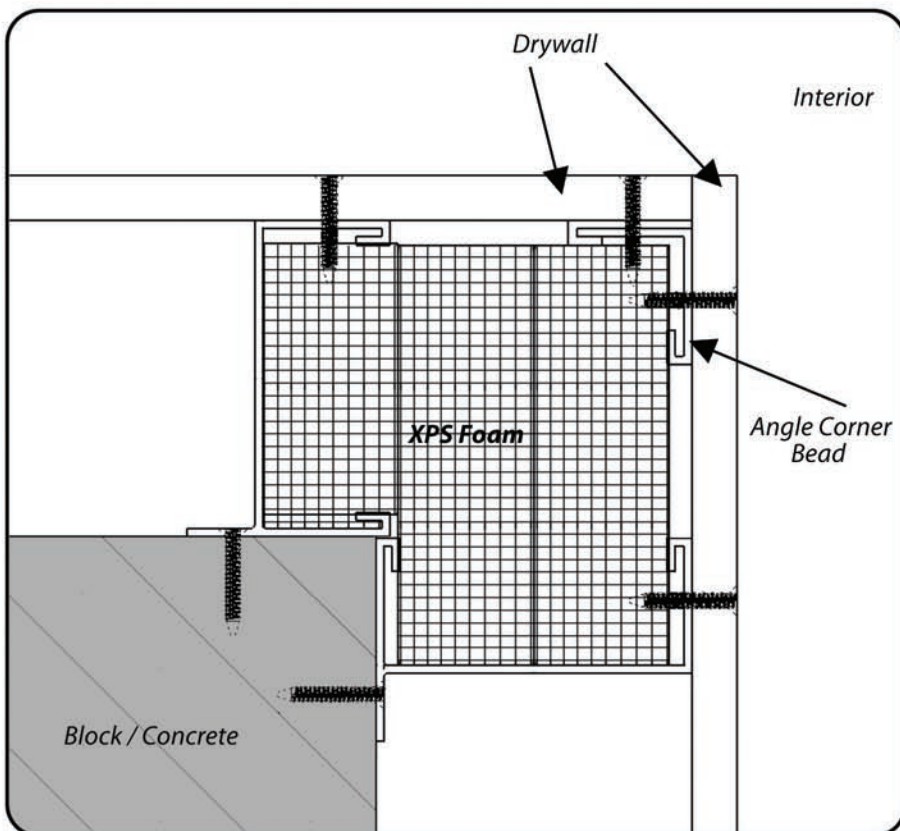
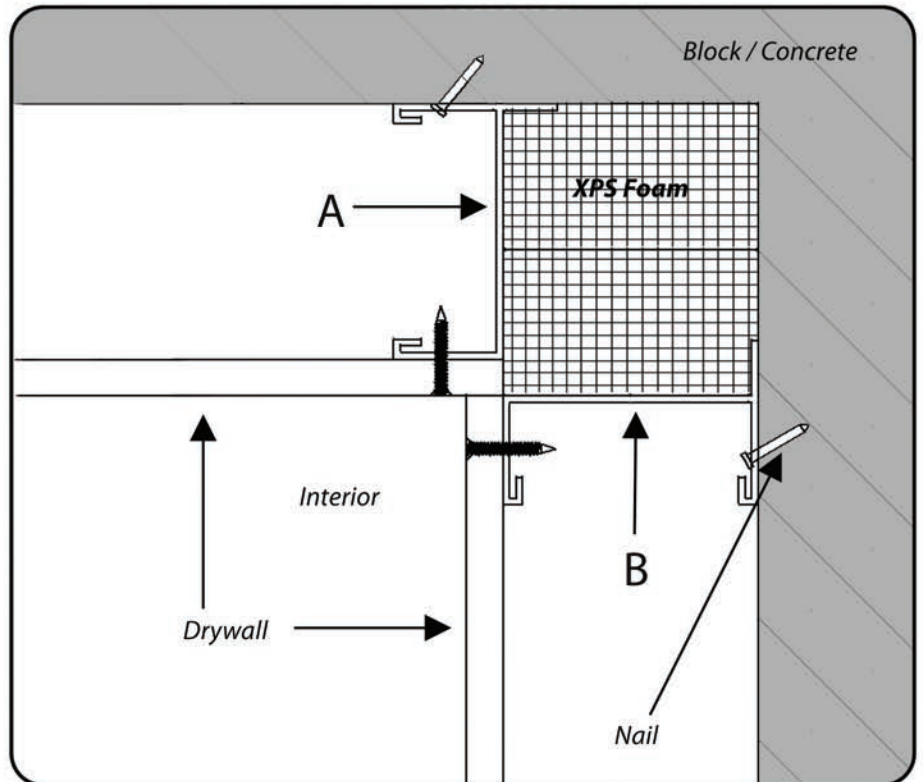

### Outside Corner

- 1.) Cut 2ea. 4 5/8" wide extruded foam. And 1 ea. 3" wide extruded foam. All 1 1/2" thick.
- 2.) Glue and nail EcoStud® as depicted.
- 3.) Install foam as depicted using glue.
- 4.) Rip an EcoStud® as depicted in fig. A and mate them together as shown in fig. B. Install with glue.

